

Aluminium Louvres

In Frame, On Wall
& In-Wall Grill

In the Louvre series. You'll find ventilation grills for permanent ventilation completely made of aluminium profiles with a thickness of 1.5mm.

The type LL38-IF has a 24mm flange surround, adapted to be mounted in a frame.

The water rejecting lamellas, consisting of 3mm round perforations, also serve as an insect prevention. Therefore an insect gauze isn't needed anymore, and the whole grill is finished in the same colour.

The water drainage holes at the bottom of frame are hidden so that the aesthetically pleasing sight lines are maintained.

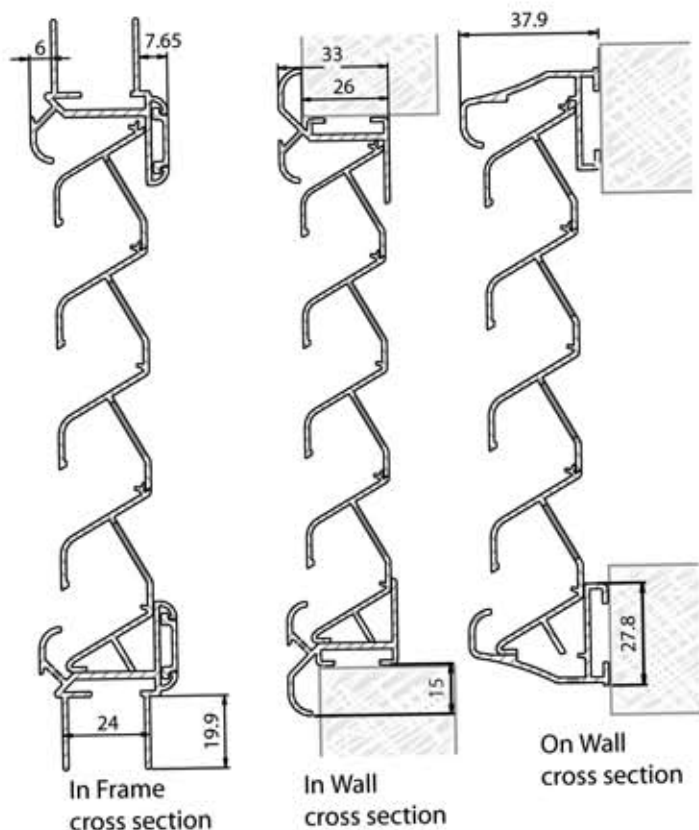

- All Ral colours available
- Free airflow 26%
- Insect prevention
- 24mm Glaze Frame
- Wall mount options available
- Made to measure

Aluminium Louvres

In Frame, On Wall
& In-Wall Grill

Louvre Line Permanent ventilation grill series:

LL38-IF: Permanent ventilation grill for in frame mounting with a depth of 38mm.

LL38-OW: Permanent ventilation grill for wall surface mounting, 38mm depth.

LL38-IW: permanent ventilation grill for in-wall mounting, 38mm depth.



IF38-IF In Frame inside



IF38-IF In Frame outside

louvre cross section

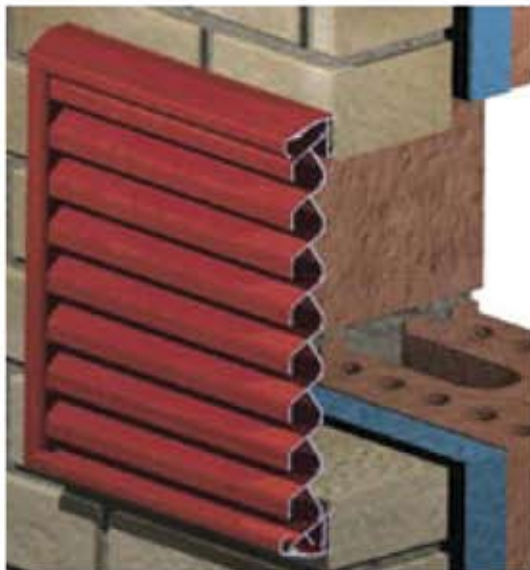

IF38-OW On Wall

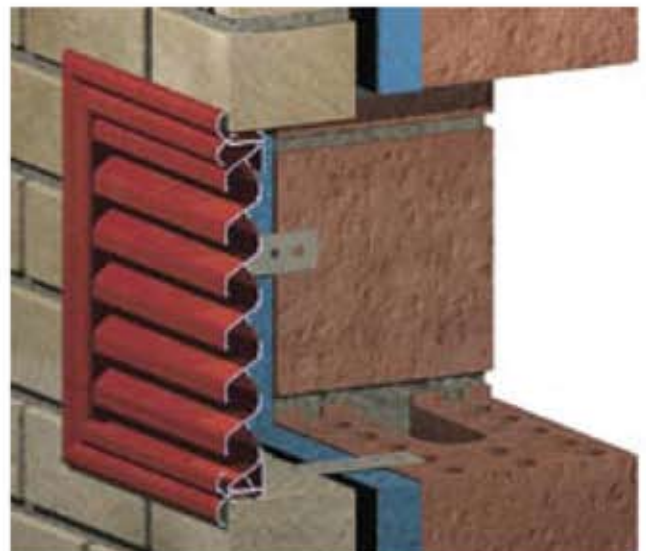

IF38-IW In-Wall